

THE  
**ULTIMATE**  
OUTBOARD MOTOR

 **SUZUKI**



2026 SUZUKI  
**OUTBOARD MOTORS**  
GENERAL CATALOGUE

## CONTENTS

4-5 **SUZUKI CLEAN OCEAN PROJECT**

6-11 **SUZUKI ULTIMATE TECHNOLOGY**

12-13 **STEALTH LINE™ Series**

14-15 **V6 350-300HP  
Flagship-GEKI Series**

DF350AMD/DF300BMD  
DF350A/DF325A/DF300B

16-17 **V6 300-250HP**  
DF300AP/DF250AP/DF250AUN

18-19 **IN-LINE 4 200-150HP**  
DF200AP/DF175AP/DF150AP

20-21 **IN-LINE 4 140-70HP**  
DF140BG/DF115BG  
DF140B/DF115B  
DF100B/DF90A/DF80A/DF70A

22-23 **IN-LINE 3 60-25HP**  
DF60AV  
DF60A/DF50A/DF40A  
DF30A/DF25A

24-25 **PORTABLE 20-2.5HP**  
DF20A/DF15A/DF9.9B  
DF9.9A  
DF6A/DF5A/DF4A  
DF2.5

28 **Integrated Control System "SYNCRO-EYE"**

29-32 **ACCESSORIES**

33 **ECSTAR**

34-39 **FEATURES & SPECIFICATIONS**



**A RELIABLE PARTNER  
FOR PLEASURE AND WORK  
ON THE WATER**

# SUZUKI CLEAN OCEAN PROJECT



Since 2020, Suzuki Clean Ocean Project has focused on reducing marine plastic waste through three key commitments:

- Clean-up the World Campaign
- Reduce Plastic Packaging
- Collect Marine Micro-Plastic Waste

## REDUCE PLASTIC PACKAGING

As part of our commitment to environmental sustainability, we are progressively replacing plastic packaging used for outboard motors and genuine marine parts with eco-conscious, sustainable alternatives – aiming to reduce plastic waste and minimise our environmental footprint.

### REDUCED PLASTIC PACKAGING – as of June 2025

- Packaging for Suzuki Marine Genuine Parts **35.9 Ton**



Plastic Packaging



Paper & Biodegradable Materials

### REDUCED PLASTIC PACKAGING – as of June 2025

- Packaging for Suzuki Outboard Motors **92.1 Ton**

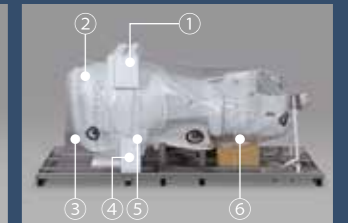
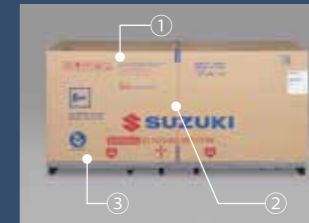

- ① **OPP Tape**  
Polypropylene → Paper
- ② **Outer Fixing Band**  
Polypropylene → Paper
- ③ **Ink (for all the ink on the carton)**  
Animal-derived ink → Botanical Ink
- ④ ⑤ **Fixing Form**  
Polystyrene Foam → 100% biomass-derived polymers
- ② **Upper Engine Cover Sheet**  
Nylon → Rayon
- ③ **Engine Cover Sheet**  
Polypropylene → 100% biomass-derived polymers
- ⑥ **Inner Fixing Band**  
Polypropylene → Paper

**TOTAL REDUCTION 128.0 Ton**

## CLEAN-UP THE WORLD CAMPAIGN

As of June 2025, more than 23,500 people from 95 groups participated in this activity.



USA



COLOMBIA



BRAZIL



CHINA



UK



KUWAIT



PAKISTAN



THAILAND



POLAND



MEXICO

## COLLECT MARINE MICRO-PLASTIC WASTE

In response to the growing issue of plastic pollution in our oceans, Suzuki has developed the world's first Micro-Plastic Collecting (MPC) device designed for integration with outboard motors.

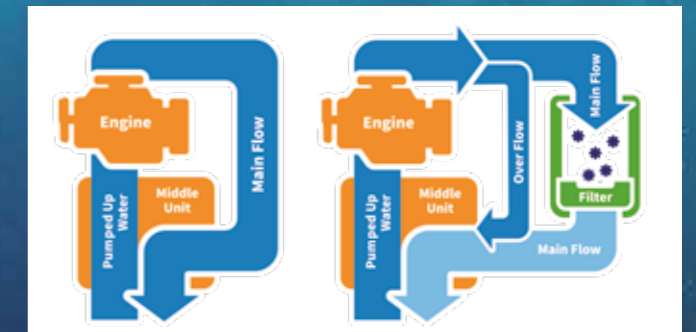

### FEATURES

- Will not affect the performance of the engine even if the filter gets clogged since this device utilises the used cooling water.
- Will not give negative effects on the environment.



**DF140BG**  
**DF115BG**

DRIVE BY WIRE

**DF140B**  
**DF115B**

MECHANICAL



LEADING THE INDUSTRY WITH AWARD WINNING TECHNOLOGIES AND DESIGNS, SUZUKI OUTBOARDS PROVIDE FEATURES AND BENEFITS THAT MAKE BOATING EVEN MORE ENJOYABLE.

## THE ULTIMATE OUTBOARD MOTOR

DURABILITY & RELIABILITY	PERFORMANCE	EASE & COMFORT	ECOLOGY & ECONOMY
<ul style="list-style-type: none"> <li>▪ Durable</li> <li>▪ Notifies user before engine trouble</li> <li>▪ Easy to service and repair</li> </ul>	<ul style="list-style-type: none"> <li>▪ Smooth and quick acceleration at all operating ranges</li> <li>▪ Powerful torque</li> </ul>	<ul style="list-style-type: none"> <li>▪ Less vibration</li> <li>▪ Quiet operation</li> <li>▪ Light &amp; compact</li> <li>▪ Easy to use</li> <li>▪ Smooth and decisive shifting</li> </ul>	<ul style="list-style-type: none"> <li>▪ Good fuel efficiency / low-emissions</li> <li>▪ Low maintenance cost</li> <li>▪ Environment protection activities</li> </ul>
DUAL LOUVER WATER DETECTING SYSTEM SELF-ADJUSTING TIMING CHAIN ANTI CORROSION KEYLESS START SYSTEM SDSM+	OFFSET DRIVESHAFT DUAL PROP MULTI-STAGE INDUCTION 2.50 GEAR RATIO HIGH ENERGY ROTATION VVT VARIABLE VALVE TIMING DIRECT INTAKE	SELECTIVE ROTATION NOISE REDUCTION PRECISION CONTROL THREE-WAY STORAGE OVERHEAD TANK TROLL MODE EASY START SYSTEM AUTOMATIC TRIM INTEGRATED STEERING SYSTEM	LEAN BURN DUAL INJECTOR LESS BATTERY-LESS FUEL INJECTION MPC

### NMMA Award

The Innovation Awards (recognising technological innovation) granted each year by the NMMA (National Marine Manufacturers Association) are considered among the highest honours in marine technology. Of the new marine industry products in that year, they are awarded to “a product that shows technical leadership, is practical and cost-effective, and is truly beneficial to the consumer.”

Starting with the DT200 Exanté in 1987 and extending to the DF350A in 2017, Suzuki outboard motors have received this Innovation Award a total of nine times. Eight of these awards are for 4-stroke outboard motors.



#### Awarded Prizes

1987: DT200 Exanté / 1997: DF70 & DF60 /  
 1998: DF50 & DF40 / 2003: DF250 /  
 2006: DF300 / 2011: DF50A & DF40A / 2012: DF300AP /  
 2014: DF30A & DF25A / 2017: DF350A

## DURABILITY & RELIABILITY



### SUZUKI DUAL LOUVER SYSTEM

▶ DF350AMD/300BMD ▶ DF350A/325A/300B

A dog-leg shaped dual louver at the air intake remove water from the air taken into the cowl.

#### ADVANTAGE

- Prevents water intrusion.
- Allows a direct intake system, contributing to higher engine output.



### SELF-ADJUSTING TIMING CHAIN

▶ DF40A AND UP

The timing chain running in an oil-bath can be adjusted automatically by an automatic hydraulic tensioner.

#### ADVANTAGE

- More durable than the belt type.
- Maintenance-free.



### DUAL WATER INLET

▶ DF350AMD/300BMD ▶ DF350A/325A/300B  
 ▶ DF300AP/250AP

The timing chain running in an oil-bath can be adjusted automatically by an automatic hydraulic tensioner.

#### ADVANTAGE

- More durable than the belt type.
- Maintenance-free.



### WATER DETECTING SYSTEM

▶ DF70A AND UP

A water detecting fuel filter prevents water intrusion. When water is detected, the system will alert the driver with visual and audio warnings.

#### ADVANTAGE

- Prevents lower power output and corrosion by avoiding water intrusion.



### TILT LIMIT SYSTEM

▶ DF60AV AND UP

Tilt Limit System prevents the outboard from tilting beyond a selected angle.

#### ADVANTAGE

- Prevents damage to the boat or outboard due to excessive outboard tilting.

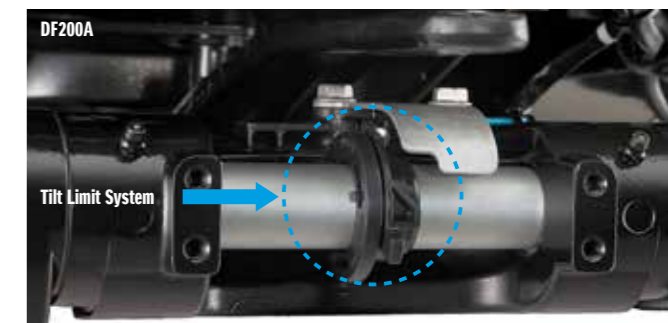

### SUB WATER INLET

OPTIONAL: ▶ DF140BG/115BG ▶ DF140B/115B  
 ▶ DF100B/DF90A/DF80A/DF70A  
 STANDARD: ▶ DF60A/50A/40A

Two water inlets in different directions ensure that the engine does not overheat due to the clogging of algae.





## KEYLESS START SYSTEM

OPTIONAL: ▶ DF70A AND UP

This system allows you to start multiple engines by placing a key-fob nearby.

- One push Start & Stop for up to 6 outboard motors.
- Waterproof floating Key Fob.
- Security support with immobiliser.

### ADVANTAGE

- Provides high security.
- No ignition key is necessary.

\*Available with SMG4



## SUZUKI ANTI-CORROSION FINISH

▶ ALL MODELS

Special protection is applied to the aluminium surface using high strength bonding to protect the aluminium made exterior parts.

### ADVANTAGE

- Protection against corrosion improves the overall outboard durability.

Resin Clear Topcoat  
Resin Black Basecoat  
Primer Undercoat  
Suzuki Anti-Corrosion Finish  
Suzuki Aluminium Alloy

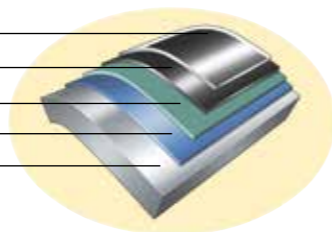

## SDSM+ (SUZUKI DIAGNOSTIC SYSTEM MOBILE+)

▶ DF9.9B AND UP\*

This app enables you to make a plan for boating with the weather forecast and check the engine condition & operation tips for the next trip. All functions are available for free.\* Please check the details in P.29 or on our website.



\*SMG4 and a smartphone running Android/iOS are required.

### ADVANTAGE

- Possible to make a plan for boat trips by checking the weather forecast in advance.
- Check up on the engines before the departure based on the engine data.
- Acquire the engine data by scanning the QR code\*.
- Provide the engine data to dealer and ask for maintenance easily.

\*DENSO WAVE owns the rights of the name and the logo of QR code.



## HIGH ENERGY ROTATION

▶ DF60AV

Larger lower units (2.42 gear ratio) make it possible to equip larger 36cm (14-inch) propeller than other models in this class. It owns good acceleration and large power.

### ADVANTAGE

- Powerful torque to carry heavy loads.
- Quick acceleration with larger propellers.
- Quick and smooth planning.

### DF60AV VS DF60A SIZE COMPARISON



MODEL	DF60AV	DF60A
GEAR RATIO	2.42	2.27



## VVT (VARIABLE VALVE TIMING)

▶ DF350AMD/300BMD ▶ DF350A/325A/300B  
▶ DF300AP/250AP ▶ DF250AUN  
▶ DF200AP/175AP/150AP

The Variable Valve Timing controls the opening and closing timing of the intake valve depending on the engine RPM.

### ADVANTAGE

- Offers smooth, powerful torque.
- Provides smooth acceleration over all speed ranges.

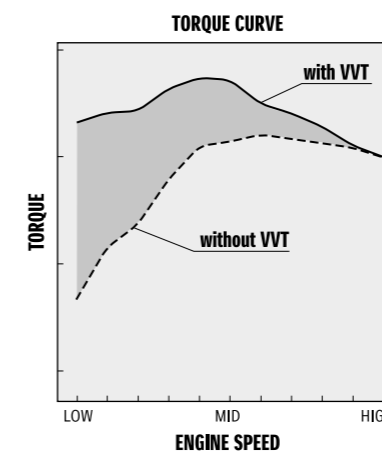

## MULTI-STAGE INDUCTION

▶ DF200AP/175AP/150AP

Manifold pipes are switched between short and long during low speed and high speed operation to ensure the right volume of air enters the engine.

### ADVANTAGE

- Increases output during high speed operation with greater volume of air input.
- Increases combustion efficiency and maximises torque during low speed operation.

### AIR FLOW IN MULTI-STAGE INDUCTION MODULE

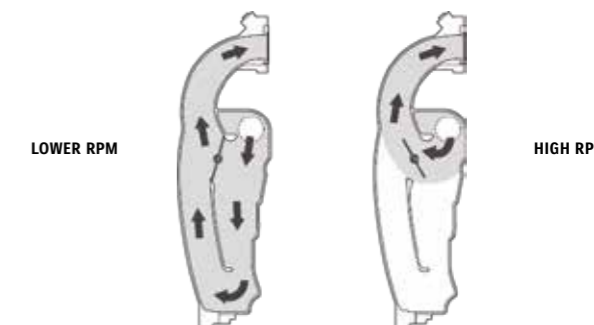

## DIRECT AIR INTAKE

▶ DF350AMD/300BMD ▶ DF350A/325A/300B

A direct airflow path from the intake port to the cylinder suppresses temperature rise of the air and improves combustion efficiency.

### ADVANTAGE

- Delivers higher power output from a small displacement.



## SUZUKI DUAL PROP SYSTEM

▶ DF350AMD/300BMD ▶ DF350A/325A/300B

The Suzuki Dual Prop System spins two propellers rotating in opposite directions on a single engine. With the 6 blades, it can make a good stroke efficiently.

### ADVANTAGE

- Achieve superior stability when driving straight.
- Powerful reverse thrust and braking force.
- Good water gripping performance and quick startup acceleration.

# PERFORMANCE



## OFFSET DRIVESHAFT

▶ DF70A AND UP

The engine powerhead is positioned closer to the front, moving the outboard's center of gravity forward.

### ADVANTAGE

- Less vibration.
- More compact.
- Stable steering performance.



1st Stage Reduction:  
30:36=1.20

2nd Stage Reduction:  
12:25=2.08

Total: 2.50:1  
**DF200AP**



## 2-STAGE GEAR REDUCTION

▶ DF70A AND UP

This design makes a larger gear ratio possible, allowing it to turn a large diameter propeller.

### ADVANTAGE

- Increased power to turn large diameter propellers, offering quick acceleration.
- High propulsive efficiency with large diameter propeller.
- Powerful navigation, maintaining propeller rotation even with a larger load.

### GEAR RATIO IN EACH CLASS

MODEL	DF140BG/115BG/ DF140B/115B DF100B/90A/80A/70A	DF200AP/ 175AP/150AP	DF300AP/ 250AP DF250AUN	DF350AMD/300BMD DF350A/325A/300B
GEAR RATIO	2.59:1	2.50:1	2.08:1	2.29:1

## EASE & COMFORT



### SUZUKI SELECTIVE ROTATION

▶ DF300AP/250AP ▶ DF200AP/175AP/150AP

Function for selecting regular or counter rotation on one outboard with an optional connector and a counter rotation propeller.

#### ADVANTAGE

- Either regular or counter rotation can be used on the same outboard.

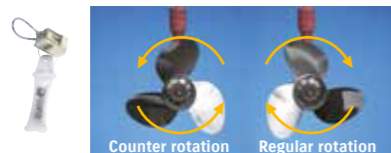

### SUZUKI PRECISION CONTROL (SPC) (Electronic Throttle and Shift Systems)

▶ DF350AMD/300BMD ▶ DF350A/325A/300B  
▶ DF300AP/250AP

Operation from the remote control is delivered to the outboard via an electric signal and it enables the 1 lever operation for up to 6 outboard motors (for dual mount only).

#### ADVANTAGE

- Less friction and resistance compared to the mechanical ones.
- Easy control for multiple outboard motors.
- Improved fuel economy with the combination of Lean Burn Control System.



Single Top Mount      Dual Top Mount      Flush Mount



### NOISE REDUCTION

▶ DF350AMD/300BMD ▶ DF350A/325A/300B  
▶ DF200AP/175AP/150AP ▶ DF200A/175A/150A  
▶ DF140BG/115BG ▶ DF140B/115B

Intake noise is suppressed with silencer and resonator.

#### ADVANTAGE

- Less noise, making boating more pleasant.

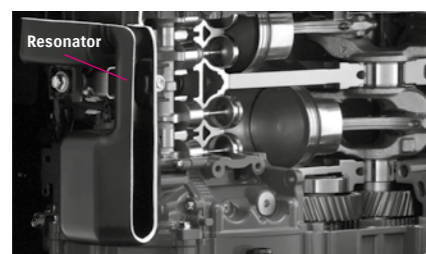

DF200A



### THREE-WAY STORAGE

▶ DF6A/5A/4A

The design allows the outboard to be removed from the boat and placed on any of its 3 sides for storage.

#### ADVANTAGE

- No need to worry about the loading space or method.

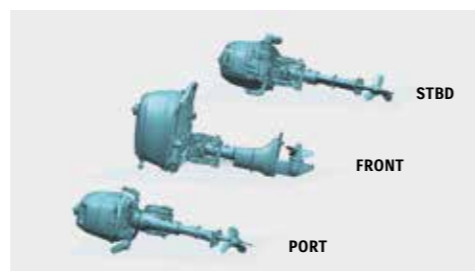

### OVERHEAD TANK

▶ DF6A/5A/4A

The integral overhead fuel tank and one-way valve delivers fuel supply by using gravity.

#### ADVANTAGE

- Contributes to easy start.



### AUTOMATIC TRIM

OPTIONAL: ▶ DF100B AND UP

The Automatic Trim adjust trim angle automatically depending on the engine RPM without your control.

#### ADVANTAGE

- Helps to keep the appropriate trim angle and contribute to achieve faster top speed and better fuel efficiency.



### SUZUKI TROLL MODE SYSTEM\*

▶ DF40A AND UP  
OPTIONAL FOR REMOTE CONTROL MODELS

This system helps the boat running at a certain speed range in low RPM.

#### ADVANTAGE

- Boat can keep running at a certain speed range in low revs without having to operate the throttle on the boat.
- Gives you highly precise control at low RPM.

\*Available with SMG4, or Troll Mode Switch Panel



### SUZUKI EASY START SYSTEM

▶ DF40A AND UP

Simply turn the key and release, and the starter stays engaged until the engine starts. This system offers a smoother start of the engine.



### INTEGRATED STEERING SYSTEM

▶ DF350AMD/300BMD

The conventional external hydraulic cylinder is built into the outboard motor.

#### ADVANTAGE

- Simple appearance of the motorwell when rigging.
- Allows rigging to various types of boats.
- Easy rigging

## ECOLOGY & ECONOMY



### BATTERY-LESS ELECTRONIC FUEL INJECTION

▶ DF30A/25A ▶ DF20A/15A/9.9B

This technology delivers quicker start, smoother operation, and more acceleration without a battery.

#### ADVANTAGE

- Operates without battery.
- Quick and easy start.
- Cleaner and economic fuel consumption.
- Higher and smoother performance in almost all operating ranges.



### DUAL INJECTOR

▶ DF350AMD/300BMD ▶ DF350A/325A/300B

The dual injector delivers just the right amount of fuel at the right time into each cylinder.

#### ADVANTAGE

- Contributes to higher output and better fuel efficiency.



### LEAN BURN CONTROL SYSTEM

▶ DF9.9B AND UP

The Lean Burn Control System supplies the appropriate amount of fuel and air mixture depending on the navigation conditions.

#### ADVANTAGE

- Significant improvement in fuel economy in all speed ranges especially at cruising speed.
- Fuel is saved and petrol costs are cut.



### MICRO-PLASTIC COLLECTING DEVICE

▶ DF140BG/115BG ▶ DF140B/115B

As one of the actions in SUZUKI CLEAN OCEAN PROJECT, we developed the device to collect micro-plastics in the oceans just by running SUZUKI's outboard motors.

#### ADVANTAGE

- Collect micro-plastics through your outboard motors.
- Not sacrificing the engine performance.



THE **ULTIMATE** OUTBOARD MOTOR



**STEALTH LINE™**



**NEW** DF350A  
DF350AMD

DF300AP

DF250AUN

**NEW** DF200AP

**NEW** DF150AP

**NEW** DF140BG  
DF140B

**NEW** DF115BG  
DF115B

**BOLD  
QUIET  
STYLISH**

**DRIVE BY WIRE**

DF350AMD DF350A DF300AP  
DF250AUN DF200AP DF150AP  
DF140BG DF115BG

**MECHANICAL**

DF140B DF115B

The bold Stealth Line from Suzuki Marine – a range of outboard motors defined by quiet power, exceptional endurance, and now, striking design. With a sleek matte black finish, chrome black graphics, and refined styling, the ONE blends renowned Suzuki performance with a commanding new look. Recognised with the 2024 Top Products Award by Boating Industry Magazine, the Stealth Line proves why Suzuki remains the ultimate choice in outboard motors.

**DURABILITY & RELIABILITY**

ANTI CORROSION	DUAL LOUVER	DUAL WATER INLET	SELF-ADJUSTING TIMING CHAIN	WATER DETECTING SYSTEM	TILT LIMIT	KEYLESS START SYSTEM	SDSM+
ALL MODELS	DF350AMD DF350A	DF350AMD DF350A DF300AP	ALL MODELS	ALL MODELS	ALL MODELS	(OPTIONAL*)	(OPTIONAL**)

**ECOLOGY & ECONOMY**

DUAL INJECTOR	LEAN BURN	MPC
DF350AMD	ALL MODELS	DF140B DF140BG DF115B DF115BG

**PERFORMANCE**

2.29 GEAR RATIO	2.08 GEAR RATIO	OFFSET DRIVESHAFT	VVT	DUAL PROP
DF350AMD DF350A	DF300AP DF250AUN	ALL MODELS	DF350AMD DF350A DF300AP DF250AUN DF200AP	DF350AMD DF350A
2.50 GEAR RATIO	2.59 GEAR RATIO	MULTI-STAGE INDUCTION		
DF200AP DF150AP	DF140B DF140BG DF115B DF115BG	DF200AP DF150AP		

**EASE & COMFORT**

SELECTIVE ROTATION	PRECISION CONTROL	TROLL MODE	EASY START SYSTEM	NOISE REDUCTION	INTEGRATED STEERING SYSTEM	AUTOMATIC TRIM
DF300AP DF200AP DF150AP	DF350AMD DF350A DF300AP DF250AUN DF200AP DF150AP DF140BG DF115BG	(OPTIONAL**)	ALL MODELS	DF350AMD DF350A DF300AP DF250AUN DF200AP DF150AP DF140B DF140BG DF115B DF115BG	DF350AMD DF350A	(OPTIONAL*)

\*1 Available with SMG4 \*2 Available with SMF4, or Troll Mode Switch Panel

SPECIFICATIONS / FEATURES P39

STEALTH LINE series | Flagship-GEKI SERIES | V6 300-250HP | IN-LINE 4, 200-150HP | IN-LINE 4, 140-70HP | IN-LINE 3 60-25HP | PORTABLE 20-2.5HP

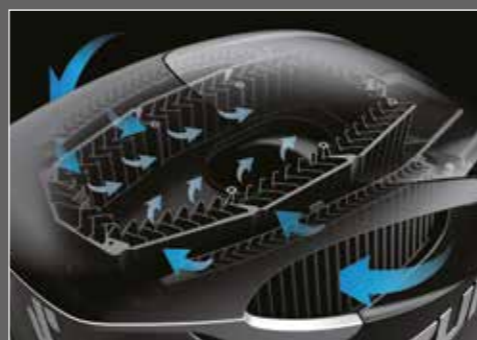

**SUZUKI DUAL LOUVER SYSTEM** P7

Dual Louver system is equipped at the air intake to remove water from the air taken into the cowl.

Incorporating a direct intake system makes the highest compression ratio of 12.0:1 (DF350AMD,DF350A), 10.5:1 (DF300BMD,DF325A/300B) possible, ultimately leading to a higher engine output.



**SUZUKI DUAL PROP SYSTEM** P9

The dual prop system efficiently transmits the horsepower output into propulsion under water. As an added benefit, because each propeller rotates in a different direction, exceptional stability is achieved.

In addition, the contra-rotating propellers produce a strong reverse thrust.



**DUAL WATER INLET** P7

The engine's cooling system relies on water supplied through low water intakes located on the lower unit. This dual water inlet configuration increases water flow into the lower unit, delivering greater cooling efficiency.



**DUAL INJECTOR** P11

Dual injectors deliver just the right amount of fuel at just the right time into the cylinder.

This dual injector contributes to higher output and better fuel efficiency.

**DRIVE BY WIRE**



**DF350AMD/  
DF350A/  
DF325/  
DF300BMD/  
DF300B**

**PARTING SEAS**

A force to match the power of nature and the sea representing Suzuki's identity and heritage. A symbol of our passion and commitment to the ultimate in marine innovation.

\* "GEKI: PARTING SEAS" is the logo that represents the DF350AMD/DF300BMD, DF350A/DF325A/DF300B

**DURABILITY & RELIABILITY**

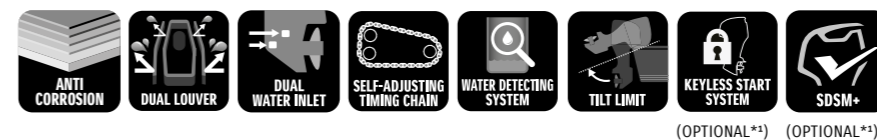

**ECOLOGY & ECONOMY**

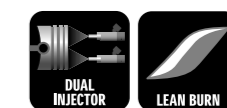

**PERFORMANCE**

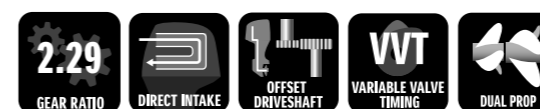

**EASE & COMFORT**



\*1 Available with SMG4 \*2 Available with SMG4, or Troll Mode Switch Panel \*3 DF350AMD/300BMD

STEALTH LINE series | Flagship-GEKI SERIES | V6 300-250HP | IN-LINE 4, 200-150HP | IN-LINE 4, 140-70HP | IN-LINE 3 60-25HP | PORTABLE 20-2.5HP



# DF300AP/ DF250AP/ DF250AUN

## STANDARD FEATURES

### DURABILITY & RELIABILITY

ANTI CORROSION	SELF-ADJUSTING TIMING CHAIN	WATER DETECTING SYSTEM	TILT LIMIT	SDSM+ (OPTIONAL*1)

### PERFORMANCE

2.08 GEAR RATIO	OFFSET DRIVESHAFT	VVT VARIABLE VALVE TIMING

DF300AP, DF250AP, DF250AUN

## ADDITIONAL FEATURES FOR DRIVE BY WIRE MODEL

### DURABILITY & RELIABILITY

DUAL WATER INLET	KEYLESS START SYSTEM (OPTIONAL*1)

DF300AP, DF250AP

### EASE & COMFORT

SELECTIVE ROTATION	PRECISION CONTROL	TROLL MODE (OPTIONAL*2)	EASY START SYSTEM	AUTOMATIC TRIM (OPTIONAL*2)

DF300AP, DF250AP, DF250AUN

### ECOLOGY & ECONOMY

LEAN BURN

DF300AP, DF250AP, DF250AUN

\*1 Available with SMG4    \*2 Available with SMG4, or Troll Mode Switch Panel



# DF200AP/ DF175AP/ DF150AP

**DRIVE BY WIRE**

## STANDARD FEATURES

### DURABILITY & RELIABILITY

ALL MODELS	ALL MODELS	ALL MODELS	ALL MODELS	(OPTIONAL*1)	(OPTIONAL*1)

### EASE & COMFORT

ALL MODELS	(OPTIONAL*2)		(OPTIONAL*2)

### ECOLOGY & ECONOMY

ALL MODELS

### PERFORMANCE

ALL MODELS	ALL MODELS	ALL MODELS	ALL MODELS

## ADDITIONAL FEATURES FOR DRIVE BY WIRE MODEL

### EASE & COMFORT

DF250AP DF175AP DF150AP	DF250AP DF175AP DF150AP

\*1 Available with SMG4 \*2 Available with SMG4, or Troll Mode Switch Panel



**DF140BG/  
DF115BG**

**DRIVE BY WIRE**

with MPC

**DF140B/  
DF115B**

**MECHANICAL**

with MPC

**DF100B/DF90A/  
DF80A/DF70A**

**MECHANICAL**

**STANDARD FEATURES**

**DURABILITY & RELIABILITY**

ANTI CORROSION	SELF-ADJUSTING TIMING CHAIN	WATER DETECTING SYSTEM	TILT LIMIT	SDSM+ (OPTIONAL*)	SUB WATER INLET (OPTIONAL)	KEYLESS START SYSTEM (OPTIONAL*)
----------------	-----------------------------	------------------------	------------	-------------------	----------------------------	----------------------------------

**PERFORMANCE**

2.59 GEAR RATIO	OFFSET DRIVESHAFT
-----------------	-------------------

**ECOLOGY & ECONOMY**

LEAN BURN	MPC
-----------	-----

**EASE & COMFORT**

TROLL MODE (OPTIONAL*)	EASY START SYSTEM	NOISE REDUCTION	AUTOMATIC TRIM (OPTIONAL*)
------------------------	-------------------	-----------------	----------------------------

**ADDITIONAL FEATURES FOR DRIVE BY WIRE MODEL**

**EASE & COMFORT**

PRECISION CONTROL
-------------------

\*1 Available with SMG4 \*2 Available with SMG4, or Troll Mode Switch Panel

STEALTH LINE SERIES | FLAGSHIP-GEKI SERIES | V6 300-250HP | IN-LINE 4, 200-150HP | IN-LINE 4, 140-70HP | IN-LINE 3 60-25HP | PORTABLE 20-2.5HP







**DF60AV**

HIGH ENERGY ROTATION

**DF60A/DF50A/  
DF40A**

**STANDARD FEATURES**

**DURABILITY & RELIABILITY**

 ANTI CORROSION ALL MODELS	 TILT LIMIT ALL MODELS	 SELF-ADJUSTING TIMING CHAIN ALL MODELS	 SDSM+ (OPTIONAL*1)	 SUB WATER INLET DF60A DF50A DF40A
---	---	--	--	---

**PERFORMANCE**

  
HIGH ENERGY ROTATION  
DF60AV

**EASE & COMFORT**

 TROLL MODE (OPTIONAL*2)	 EASY START SYSTEM ALL MODELS
---	--

**ECOLOGY & ECONOMY**

  
LEAN BURN  
ALL MODELS

\*1 Available with SMG4    \*2 Available with SMG4, or Troll Mode Switch Panel

THE  
**ULTIMATE**  
OUTBOARD MOTOR



**DF30A/  
DF25A**

BATTERY-LESS EFI

Remote Control Model Available

**STANDARD FEATURES**

**DURABILITY & RELIABILITY**

 ANTI CORROSION ALL MODELS	 SDSM+ (OPTIONAL*1)
---	--

**ECOLOGY & ECONOMY**

 LEAN BURN ALL MODELS	 MPC ALL MODELS
--	--

\*1 Available with SMG4

SPECIFICATIONS / FEATURES P37

STEALTH LINE SERIES |  
Flagship-GEKI SERIES |  
V6 300-250HP |  
IN-LINE 4, 200-150HP |

IN-LINE 4, 140-70HP |  
IN-LINE 3 60-25HP |

PORTABLE 20-2.5HP



# DF20A/ DF15A/ DF9.9B

BATTERY-LESS EFI



DF9.9A



DF6A/  
DF5A/  
DF4A

THREE WAY STORAGE



DF2.5

### STANDARD FEATURES

#### DURABILITY & RELIABILITY



ANTI CORROSION

ALL MODELS



SDSM+

(OPTIONAL\*)

DF20A

DF15A

DF9.9B

#### EASE & COMFORT



THREE-WAY STORAGE

DF6A

DF5A

DF4A



OVERHEAD TANK

DF6A

DF5A

DF4A

#### ECOLOGY & ECONOMY



LEAN BURN

DF20A

DF15A

DF9.9B



LESS BATTERY-LESS FUEL INJECTION

DF20A

DF15A

DF9.9B

\*1 Available with SMG4





# INTEGRATED CONTROL SYSTEM



## SUZUKI'S TECHNOLOGY VISION

"SYNCRE-EYE" is a comprehensive system Suzuki has developed which "connects" various devices so that they may work together in synchronisation. This innovative system will also improve the control technology of the boat by "sensing" various situations surrounding the boat and be compatible with future technologies.

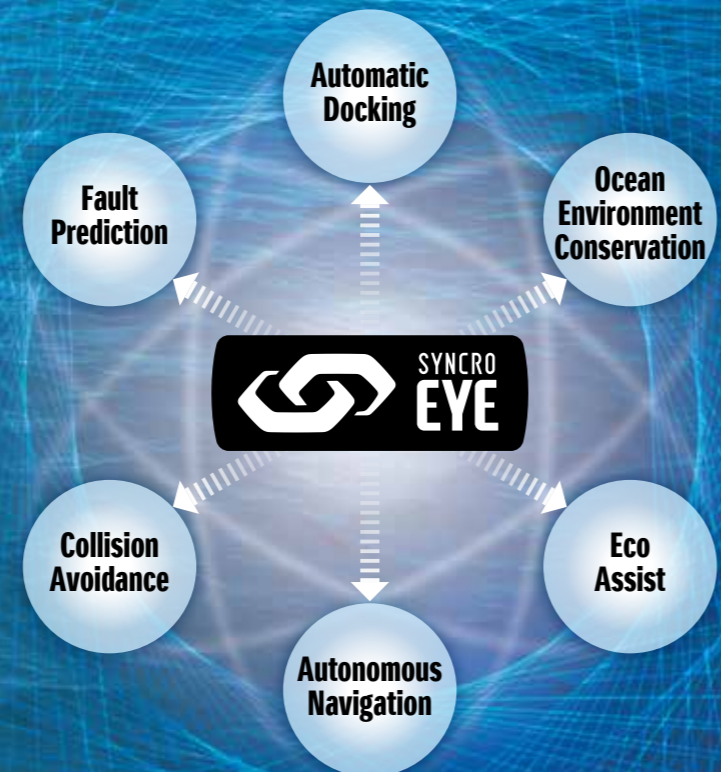

# ACCESSORIES

## SUZUKI DIAGNOSTIC SYSTEM MOBILE PLUS (SDSM+)

► DF9.9B AND UP\*

\*Available with SMG4

You can have more fulfilling marine experiences with SDSM+.

\*The SDSM+ is a free app. SMG4 is required to access engine data.

### 3 FEATURES OF THE SDSM+

#### 1. PLAN A BOAT TRIP WITH THE FORECAST\*

- You can make a boating plan along with referring to the weather, wind, and wave condition of a designated point.
- The app also shows the weekly weather forecast, which will be constantly updated.

\*You need to input your boat information.

#### 2. INSPECT BOAT AND OUTBOARD MOTOR IN ADVANCE

- Outboard motor can be checked based on the engine data.
- You can inspect boat and engine in advance based on the check list.

#### 3. ACQUIRE ENGINE DATA

- You can check the engine condition and your driving tendencies.
- You can share engine data with your dealer, which can shorten the service time.



Apple and the Apple logo are trademarks of Apple Inc., registered in the U.S. and other countries. App Store is a service mark of Apple Inc., registered in the U.S. and other countries.

Google Play and the Google Play logo are trademarks of Google LLC.

### HOW TO GET THE ENGINE DATA

1. The outboard will convert engine data into a QR code\* displayed on the SMG4.
2. Open the app and scan the QR code. The app will receive the engine data and automatically attach it to an email.
3. You can then send the e-mail to your nearby dealer to shorten the maintenance time.

\*DENSO WAVE owns the rights of the name and the logo of QR code.



Find out more at our global website

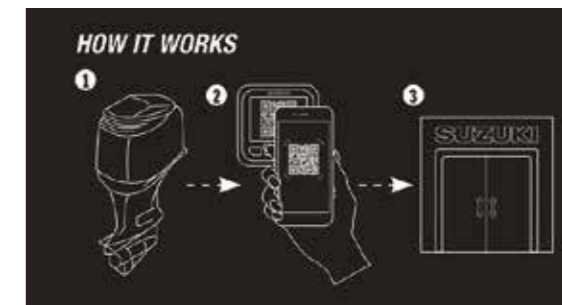

## SUZUKI PRECISION CONTROL (SPC) (ELECTRONIC THROTTLE AND SHIFT SYSTEMS)

► DF350AMD/300BMD ► DF350A/325A/300B ► DF300AP/250AP ► DF250AUN ► DF200AP/175AP/150AP ► DF140BG/115BG

Suzuki's best technology lies in the SUZUKI PRECISION CONTROL (SPC) (Electronic Throttle and Shift Systems). SPC enables instant, precise throttle response for greater control and accuracy.



Find out more at our global website

### FEATURES

- Controls up to 6 outboard motors.
- 1-action start for multi-motor boats: Motors start in order from port to starboard.
- Automatic Trim is available with SMG4.
- 1 Lever Operation: This switch allows multiple motor operation with just 1 lever.(Dual top mount only)
- Integrated Emergency Switch (Flush Mount only)

### REMOTE CONTROL BOX

Integrated "Select" and "Throttle Only" switch (All)



Single Top Mount      Dual Top Mount      Flush Mount

### CONTROL PANEL



### SWITCH PANEL FOR REGULAR KEY



## KEYLESS START SYSTEM\*

► DF70A AND UP

### DESIGN

#### HOW TO USE

- Stand nearby the console with the key fob.
- Push START/STOP button to start engine.
- To turn off the engine, push the button again.

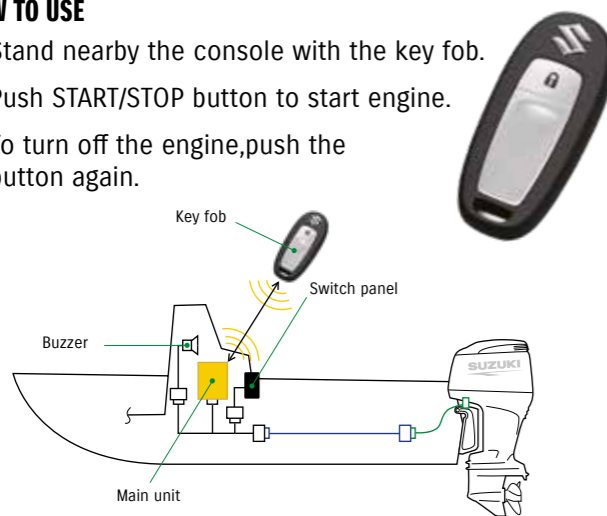

### FEATURES

- 3 types of panels are available: Vertical, Horizontal and Separate.
- 1-push Start/Stop, and controls up to 6 engines. No ignition key necessary.



Find out more by watching our videos

\*Please check applicability with your local Suzuki dealer.

## SUZUKI MULTI-FUNCTION GAUGE (SMG4)

Suzuki Multi-Function Gauge provides all performance information in one gauge.

Individual elements can also be emphasised to further enhance user friendliness.

### SMG4



Day mode

Night mode

### FEATURES

#### MULTILINGUAL MENU



English, French, Italian, German, Spanish, Swedish, Norwegian, Finnish, Dutch, Portuguese, Danish, Russian, Japanese. Chinese version is also available.

► DF9.9B AND UP

### SPECIFICATIONS

- 3.5 Colour Display
- Size: 105mm(W)x105mm(H)x16mm(D)
- NMEA2000 output
- Shows both digital and analogue readouts, as well as day/night mode
- Displays the QR code\* for SDSM+
- Troll Mode Function: Allows user to control troll mode (only for 2019MY ~ models adapted to troll mode)

\*DENSO WAVE owns the rights of the name and the logo of QR code.

### ANALOG TACHO & SPEED MODE

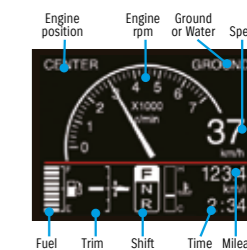

### TROLL MODE



#### AUTOMATIC TRIM FUNCTION



Automatically adjusts trim angle.



## SUZUKI ULTIMATE RIGGING SELECTOR

The Suzuki Ultimate Rigging Selector is a new website that Suzuki Motor Corporation released. The website is designed to assist users in choosing which Part Number they will need for their desired application.

Required Items					
	PART NUMBER	NAME	QTY	NOTES	REMARKS
KIT	87600-8803-000	KIT, SINGLE ENGINE, 1st station	1	Kit details	Click here to check kit components.
A	37100-8800-000	MAIN SWITCH PANEL	1		
B	37800-8800-000	EMERGENCY SWITCH PANEL	1		
C	38620-8800-000	MAIN WIRING HARNESS(3m / 21.3ft)	1		
D	38620-8820-000	MAIN WIRING HARNESS Extension (2m / 6.5ft)	1	Optional	
E	37800-8800-000	TROLL MODE SWITCH PANEL	1	Optional	
GAUGE	34011-9804-000	SUZUKI MULTI-FUNCTION GAUGE (SMG4)	1		
GAUGE	38601-8800-000	CABLE KIT for SMG4	1	Kit details	MSC Single-source: Check kit details in Parts List Section.
Optional 1-1	34150-8800-000	SENSOR ASSY, PADDLE WHEEL (Speed Over Water)	1	Optional	MSC Single-source: 99000-88317-000
Optional 1-2	39950-8802-000	GPS RECEIVER MODULE (Speed Over Ground)	1	Optional	

Click here to see the current selection.



# ACCESSORIES

## WATERGRIP PROPELLER

WATERGRIP is a stainless-steel propeller series offering accurate response to your operation. With efficient conversion of engine power into propulsion, this propeller series meets our customers' demand for bigger, faster, more powerful outboards.

The WATERGRIP propeller series employs a new interchangeable and square shaped propeller bush that minimises power loss in delivery.

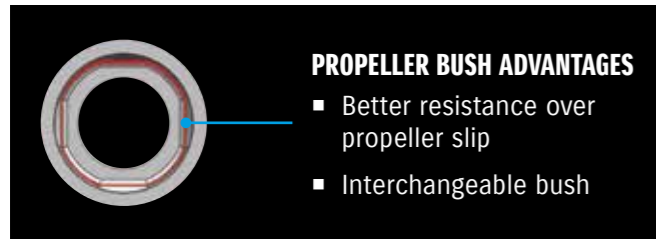

### PROPELLER BUSH ADVANTAGES

- Better resistance over propeller slip
- Interchangeable bush



## MULTI-FUNCTION TILLER HANDLE

▶ DF115B ▶ DF100B/90A/80A/70A ▶ DF60A/60AV ▶ DF50A/40A



Tachometer with warning indicators.



Three-position angle adjustable bracket.



Power trim & tilt switch and throttle grip friction adjuster.



Troll mode switch

- Activates SUZUKI Troll Mode System and controls RPM from idling engine speed up to 1200rpm at every 50rpm.

## MAINTENANCE KITS

Suzuki provides Maintenance Kits for speedy and reliable service. Each kit comes with all the periodic maintenance parts necessary for each model.

Please ask your local Suzuki dealer for the contents of each kit and applicable models.



# ECSTAR

GENUINE OIL & CHEMICAL

## What is ECSTAR

ECSTAR is a global brand name of SUZUKI Genuine Oil & Chemicals.

## The ULTIMATE Formulation

Suzuki Approved Genuine engine oils have all been rigorously tested and certified by Suzuki engineers. You can be confident that they'll help keep your Suzuki outboard in perfect condition, giving you maximum performance and reliability over its lifetime.

## Replacement Guideline (Engine Oil & Gear Oil)

Interval	1st time	20 hours or 1 month*
		From 2nd time

\*whichever comes first

This guideline may vary by outboard motor model, condition of use, region, etc. Please refer to the owner's manual or ask an Authorised Suzuki Dealer for more information.

## ECSTAR Line up for OUTBOARD MOTOR



Availability may differ in some regions. Please contact your local Suzuki dealer.

# SPECIFICATIONS & FEATURES



## SPECIFICATIONS

	350AMD	300BMD	350A	325A	300B	300AP	250AP	250AUN		200AP	175AP	150AP	140BG	115BG	140B	115B			
<b>Starting System</b>	Electric		Electric		Electric		Electric		<b>Starting System</b>	Electric		Electric		Electric		Electric			
<b>Recommended Transom Height (mm)</b>	X:635 XX:762		X: 635 XX: 762		X: 635 XX:762*3		X: 290 XX:299*3		<b>Recommended Transom Height (mm)</b>	L: 508 X: 635		L: 508 X: 635		L: 508 X:635		L:508 X:635			
<b>Weight (kg)*1</b>	X:352 XX:360		X: 330 XX: 338		X: 290 XX:299*3		X: 290 XX:299*3		<b>Weight (kg)*1</b>	L: 236 X: 241		L: 188 X: 192		L: 190 X: 194		L: 186 X: 190		L: 188 X: 192	
<b>Valve Train</b>	DOHC 24-Valve		DOHC 24-Valve		DOHC 24-Valve		DOHC 24-Valve		<b>Valve Train</b>	DOHC 16-Valve		DOHC 16-Valve		DOHC 16-Valve		DOHC 16-Valve		DOHC 16-Valve	
<b>Valve Train Drive</b>	Chain		Chain		Chain		Chain		<b>Valve Train Drive</b>	Chain		Chain		Chain		Chain		Chain	
<b>Displacement (cm<sup>3</sup>)</b>	4,390		4,390		4,028		4,028		<b>Displacement (cm<sup>3</sup>)</b>	2,867		2,045		2,045		2,045		2,045	
<b>Maximum Output (kW)</b>	257.4	220.7	257.4	239.0	220.7	220.7	183.9	183.9	<b>Maximum Output (kW)</b>	147.1	128.7	110.3	103.0	84.6	103.0	84.6	103.0	84.6	84.6
<b>Bore and Stroke (mm)</b>	98 × 97		98 × 97		98 × 89		98 × 89		<b>Bore and Stroke (mm)</b>	97 × 97		86 × 88		86 × 88		86 × 88		86 × 88	
<b>Operation Range (rpm)</b>	5,700-6,300	5,300-6,300	5,700-6,300	5,300-6,300	5,700-6,300	5,500-6,100	5,700-6,300	5,700-6,300	<b>Operation Range (rpm)</b>	5,500-6,100	5,000-6,000	5,000-6,000	5,700-6,300	5,000-6,000	5,700-6,300	5,000-6,000	5,700-6,300	5,000-6,000	5,000-6,000
<b>Fuel Delivery System</b>	Electronic Fuel Injection		Electronic Fuel Injection		Electronic Fuel Injection		Electronic Fuel Injection		<b>Fuel Delivery System</b>	Electronic Fuel Injection		Electronic Fuel Injection		Electronic Fuel Injection		Electronic Fuel Injection		Electronic Fuel Injection	
<b>Oil Pan Capacity (L)</b>	8.0		8.0		8.0		8.0		<b>Oil Pan Capacity (L)</b>	8.0		5.5		5.5		5.5		5.5	
<b>Alternator</b>	12V 54A		12V 54A		12V 54A		12V 54A		<b>Alternator</b>	12V 44A		12V 40A		12V 40A		12V 40A		12V 40A	
<b>Trim Type</b>	Power Trim and Tilt		Power Trim and Tilt		Power Trim and Tilt		Power Trim and Tilt		<b>Trim Type</b>	Power Trim and Tilt		Power Trim and Tilt		Power Trim and Tilt		Power Trim and Tilt		Power Trim and Tilt	
<b>Gear Ratio</b>	2.29:1		2.29:1		2.08:1		2.08:1		<b>Gear Ratio</b>	2.50:1		2.59:1		2.59:1		2.59:1		2.59:1	
<b>Control System</b>	Drive By Wire		Drive By Wire		Drive By Wire		Drive By Wire		<b>Control System</b>	Drive By Wire		Drive By Wire		Drive By Wire		Mechanical		Mechanical	
<b>Recommended Fuel*2</b>	RON94/AKI89	RON91/AKI87	RON94/AKI89	RON91/AKI87	RON94/AKI89	RON94/AKI89	RON94/AKI89	RON94/AKI89	<b>Recommended Fuel*2</b>	RON91/AKI87		RON91/AKI87		RON91/AKI87		RON91/AKI87		RON91/AKI87	
<b>Propeller Selection (pitch)</b>	12"-31.5"		12"-31.5"		15"-27.52(R/R) 17"-26"(C/R)*3		15"-27.52(R/R) 17"-26"(C/R)*3		<b>Propeller Selection (pitch)</b>	15"-27.5"(R/R) 17"-26"(C/R)		15"-25"(R/R) 17"-23"(C/R)		15"-25"(R/R) 17"-23"(C/R)		15"-25"(R/R) 17"-23"(C/R)		15"-25"(R/R) 17"-23"(C/R)	

All propellers are the 3-blade type. please inquire at your local dealer for details of the propeller.

\*1: Dry Weight: Including battery cable, not including propeller and engine oil. \*2: RON: Research method (minimum octane rating) AKI: (R+M)/2 method(minimum pump octane rating), (Only North America)

\*3: DF300AP/DF250AP only

## FEATURES

●=Standard Equip. ○=Optional Equip.

	350AMD	300BMD	350A	325A	300B	300AP	250AP	250AUN		200AP	175AP	150AP	140BG	115BG	140B	115B
<b>INTEGRATED STEERING</b>	●	●							<b>INTEGRATED STEERING</b>							
<b>SUZUKI DUAL LOUVER SYSTEM</b>	●	●	●	●	●				<b>SUZUKI DUAL LOUVER SYSTEM</b>							
<b>SELF-ADJUSTING TIMING CHAIN</b>	●	●	●	●	●	●	●	●	<b>SELF-ADJUSTING TIMING CHAIN</b>	●	●	●	●	●	●	●
<b>SUZUKI ANTI-CORROSION SYSTEM</b>	●	●	●	●	●	●	●	●	<b>SUZUKI ANTI-CORROSION SYSTEM</b>	●	●	●	●	●	●	●
<b>OVER-REV. LIMITER</b>	●	●	●	●	●	●	●	●	<b>OVER-REV. LIMITER</b>	●	●	●	●	●	●	●
<b>TILT LIMIT SYSTEM</b>	●	●	●	●	●	●	●	●	<b>TILT LIMIT SYSTEM</b>	●	●	●	●	●	●	●
<b>WATER DETECTING SYSTEM</b>	●	●	●	●	●	●	●	●	<b>WATER DETECTING SYSTEM</b>	●	●	●	●	●	●	●
<b>FRESH WATER FLUSHING SYSTEM</b>	●	●	●	●	●	●	●	●	<b>FRESH WATER FLUSHING SYSTEM</b>	●	●	●	●	●	●	●
<b>DUAL WATER INLET</b>	●	●	●	●	●	●	●	●	<b>DUAL WATER INLET</b>							
<b>SUB WATER INLET</b>									<b>SUB WATER INLET</b>				○	○	○	○
<b>KEYLESS START SYSTEM</b>	○	○	○	○	○	○	○	○	<b>KEYLESS START SYSTEM</b>	○	○	○	○	○	○	○
<b>SDSM*1</b>	○	○	○	○	○	○	○	○	<b>SDSM*1</b>	○	○	○	○	○	○	○
<b>OFFSET DRIVESHAFT</b>	●	●	●	●	●	●	●	●	<b>OFFSET DRIVESHAFT</b>	●	●	●	●	●	●	●
<b>2-STAGE GEAR REDUCTION</b>	●	●	●	●	●	●	●	●	<b>2-STAGE GEAR REDUCTION</b>	●	●	●	●	●	●	●
<b>HIGH ENERGY ROTATION</b>									<b>HIGH ENERGY ROTATION</b>							
<b>SUZUKI DUAL PROP SYSTEM</b>	●	●	●	●	●				<b>SUZUKI DUAL PROP SYSTEM</b>							
<b>VARIABLE VALVE TIMING</b>	●	●	●	●	●	●	●	●	<b>VARIABLE VALVE TIMING SYSTEM</b>	●	●	●				
<b>MULTI-STAGE INDUCTION</b>									<b>MULTI-STAGE INDUCTION</b>	●	●	●				
<b>SUZUKI SELECTIVE ROTATION</b>						●	●		<b>SUZUKI SELECTIVE ROTATION</b>	●	●	●				
<b>SUZUKI PRECISION CONTROL</b>	●	●	●	●	●	●	●	●	<b>SUZUKI PRECISION CONTROL</b>	●	●	●	●	●	●	●
<b>NOISE REDUCTION</b>	●	●	●	●	●				<b>NOISE REDUCTION</b>	●	●	●	●	●	●	●
<b>OVERHEAD TANK</b>									<b>OVERHEAD TANK</b>							
<b>AUTOMATIC TRIM*3</b>	○	○	○	○	○	○	○	○	<b>AUTOMATIC TRIM*3</b>	○	○	○	○	○	○	○
<b>GAS ASSIST SYSTEM</b>									<b>GAS ASSIST SYSTEM</b>							
<b>THREE-WAY STORAGE</b>									<b>THREE-WAY STORAGE</b>							
<b>SUZUKI TROLL MODE SYSTEM*2</b>	○	○	○	○	○	○	○	○	<b>SUZUKI TROLL MODE SYSTEM*2</b>	○	○	○	○	○	○	○
<b>SUZUKI EASY START SYSTEM</b>	●	●	●	●	●	●	●	●	<b>SUZUKI EASY START SYSTEM</b>	●	●	●	●	●	●	●
<b>LEAN BURN CONTROL SYSTEM</b>	●	●	●	●	●	●	●	●	<b>LEAN BURN CONTROL SYSTEM</b>	●	●	●	●	●	●	●
<b>DUAL INJECTOR</b>	●	●	●	●	●				<b>DUAL INJECTOR</b>							
<b>O<sub>2</sub> SENSOR FEEDBACK CONTROL SYSTEM</b>						●	●	●	<b>O<sub>2</sub> SENSOR FEEDBACK CONTROL SYSTEM</b>	●	●	●	●	●	●	●
<b>SHALLOW WATER DRIVE</b>									<b>SHALLOW WATER DRIVE</b>							

\*1: available by using with SMG4 \*2: available by using with SMG4/Troll Mode Switch Panel

# SPECIFICATIONS & FEATURES

## SPECIFICATIONS

	100B	90A	80A	70A		60A/50A/40A	60AV	30A/25A
<b>Starting System</b>	Electric				<b>Starting System</b>	Electric		Electric**
<b>Recommended Transom Height (mm)</b>	L: 508 X: 635				<b>Recommended Transom Height (mm)</b>	S: 381 L: 508 X: 635*3	L: 508 X: 635*3	S: 381 L: 508
<b>Weight (kg)*1</b>	L: 157 X: 161	L: 156 X: 160			<b>Weight (kg)*1</b>	S: 102 L: 104 X: 107*3	L: 115	S: 65 L: 63
<b>Valve Train</b>	DOHC 16-Valve				<b>Valve Train</b>	DOHC 12-Valve		OHC
<b>Valve Train Drive</b>	Chain				<b>Valve Train Drive</b>	Chain		Belt
<b>Displacement (cm<sup>3</sup>)</b>	1,502				<b>Displacement (cm<sup>3</sup>)</b>	941		490
<b>Maximum Output (kW)</b>	73.6	66.2	58.8	51.5	<b>Maximum Output (kW)</b>	DF60A: 44.1 DF50A: 36.8 DF40A: 29.4	44.1	DF30A: 22.1 DF25A: 18.4
<b>Bore and Stroke (mm)</b>	75 × 85				<b>Bore and Stroke (mm)</b>	72.5 × 76		60.4 × 57
<b>Operation Range (rpm)</b>	5,700-6,300		5,000-6,000		<b>Operation Range (rpm)</b>	DF60A/50A: 5,300-6,300 DF40A: 5,000-6,000	5,300-6,300	DF30A: 5,300-6,300 DF25A: 5,000-6,000
<b>Fuel Delivery System</b>	Electronic Fuel Injection				<b>Fuel Delivery System</b>	Electronic Fuel Injection		Battery-less Electronic Fuel Injection
<b>Oil Pan Capacity (L)</b>	4.3				<b>Oil Pan Capacity (L)</b>	2.7		1.5
<b>Alternator</b>	12V 27A				<b>Alternator</b>	12V 19A		12V 14A
<b>Trim Type</b>	Power Trim and Tilt				<b>Trim Type</b>	Power Trim and Tilt	Power Trim and Tilt	Manual Trim and Tilt
<b>Gear Ratio</b>	2.59:1				<b>Gear Ratio</b>	2.27:1	2.42:1	2.09:1
<b>Control System</b>	Mechanical				<b>Control System</b>	Mechanical		Mechanical
<b>Recommended Fuel*2</b>	RON91/AK187				<b>Recommended Fuel*2</b>	RON91/AK187		RON91/AK187
<b>Propeller Selection(pitch)</b>	13"-25"(R/R)				<b>Propeller Selection(pitch)</b>	9"-17"		9"-15"

All propellers are the 3-blade type. please inquire at your local dealer for details of the propeller.

\*1: Dry Weight: Including battery cable, not including propeller and engine oil. \*2: RON: Research method (minimum octane rating) AKI: (R+M)/2 method(minimum pump octane rating ), (Only North America)

\*3: DF60A only. \*4: DF25AE only.

●=Standard Equip. ○=Optional Equip

	100B	90A	80A	70A		60A/50A/40A	60AV	30A/25A
<b>SUZUKI DUAL LOUVER SYSTEM</b>					<b>SUZUKI DUAL LOUVER SYSTEM</b>			
<b>SELF-ADJUSTING TIMING CHAIN</b>	●	●	●	●	<b>SELF-ADJUSTING TIMING CHAIN</b>	●	●	
<b>SUZUKI ANTI-CORROSION SYSTEM</b>	●	●	●	●	<b>SUZUKI ANTI-CORROSION SYSTEM</b>	●	●	●
<b>OVER-REV. LIMITER</b>	●	●	●	●	<b>OVER-REV. LIMITER</b>	●	●	●
<b>TILT LIMIT SYSTEM</b>	●	●	●	●	<b>TILT LIMIT SYSTEM</b>	●	●	
<b>WATER DETECTING SYSTEM</b>	●	●	●	●	<b>WATER DETECTING SYSTEM</b>			
<b>FRESH WATER FLUSHING SYSTEM</b>	●	●	●	●	<b>FRESH WATER FLUSHING SYSTEM</b>	●	●	●
<b>DUAL WATER INLET</b>					<b>DUAL WATER INLET</b>			
<b>SUB WATER INLET</b>					<b>SUB WATER INLET</b>	●		
<b>KEYLESS START SYSTEM</b>	○	○	○	○	<b>KEYLESS START SYSTEM</b>			
<b>SDSM*1</b>	○	○	○	○	<b>SDSM*1</b>	○	○	○
<b>OFFSET DRIVESHAFT</b>	●	●	●	●	<b>OFFSET DRIVESHAFT</b>			
<b>2-STAGE GEAR REDUCTION</b>	●	●	●	●	<b>2-STAGE GEAR REDUCTION</b>			
<b>HIGH ENERGY ROTATION</b>					<b>HIGH ENERGY ROTATION</b>		●	
<b>SUZUKI DUAL PROP SYSTEM</b>					<b>SUZUKI DUAL PROP SYSTEM</b>			
<b>VARIABLE VALVE TIMING SYSTEM</b>					<b>VARIABLE VALVE TIMING SYSTEM</b>			
<b>MULTI-STAGE INDUCTION</b>					<b>MULTI-STAGE INDUCTION</b>			
<b>SUZUKI SELECTIVE ROTATION</b>					<b>SUZUKI SELECTIVE ROTATION</b>			
<b>SUZUKI PRECISION CONTROL</b>					<b>SUZUKI PRECISION CONTROL</b>			
<b>NOISE REDUCTION</b>					<b>NOISE REDUCTION</b>			
<b>OVERHEAD TANK</b>					<b>OVERHEAD TANK</b>			
<b>AUTOMATIC TRIM**</b>					<b>AUTOMATIC TRIM**</b>			
<b>GAS ASSIST SYSTEM</b>					<b>GAS ASSIST SYSTEM</b>			
<b>THREE-WAY STORAGE</b>					<b>THREE-WAY STORAGE</b>			
<b>SUZUKI TROLL MODE SYSTEM*2</b>	○	○	○	○	<b>SUZUKI TROLL MODE SYSTEM*2</b>	○	○	
<b>SUZUKI EASY START SYSTEM</b>	●	●	●	●	<b>SUZUKI EASY START SYSTEM</b>	●	●	
<b>LEAN BURN CONTROL SYSTEM</b>	●	●	●	●	<b>LEAN BURN CONTROL SYSTEM</b>	●	●	●
<b>DUAL INJECTOR</b>					<b>DUAL INJECTOR</b>			
<b>O<sub>2</sub> SENSOR FEEDBACK CONTROL SYSTEM</b>					<b>O<sub>2</sub> SENSOR FEEDBACK CONTROL SYSTEM</b>			
<b>SHALLOW WATER DRIVE</b>					<b>SHALLOW WATER DRIVE</b>			●

\*1: available by using with SMG4 \*2: available by using with SMG4/Troll Mode Switch Panel

# SPECIFICATIONS & FEATURES



## SPECIFICATIONS

	20AT/15AT/9.9BT	20AR/ 15AR/9.9BR	20A/15A/ 9.9B	9.9A	6A/5A/4A	2.5		350AMD (STEALTH LINE)	300AP (STEALTH LINE)	250AUN (STEALTH LINE)	
<b>Starting System</b>	Electric/Manual	Electric/Manual		Manual	Manual	Manual	<b>Starting System</b>	Electric	Electric		
<b>Recommended Transom Height (mm)</b>	S: 381*3 L: 508	S: 381 L: 508		S: 381 L: 508	S: 381 L: 508	S: 381 L: 508	<b>Recommended Transom Height (mm)</b>	X: 635 XX: 762	X: 635 XX: 762	X: 635	
<b>Weight (kg)*1</b>	S: 52.5*3 L: 54.5	S: 47 L: 48	S: 48 L: 49	S: 44 L: 45	S: 39 L: 41.5	S: 24 L: 25	S: 13.5 L: 14	<b>Weight (kg)*1</b>	X: 352 XX: 360	X: 290 XX: 299	X: 290
<b>Valve Train</b>	OHC	OHC		OHC	OHV	OHV	<b>Valve Train</b>	DOHC 24-Valve	DOHC 24-Valve		
<b>Valve Train Drive</b>	Belt	Belt		Belt	Pushrod	Pushrod	<b>Valve Train Drive</b>	Chain	Chain		
<b>Displacement (cm³)</b>	327	327		208	138	68	<b>Displacement (cm³)</b>	4,390	4,028		
<b>Maximum Output (kW)</b>	DF20A: 14.7 DF15A: 11.0 DF9.9B: 7.3	DF20A: 14.7 DF15A: 11.0 DF9.9B: 7.3		DF9.9A: 7.3	DF6A: 4.4 DF5A: 3.7 DF4A: 2.9	1.8	<b>Maximum Output (kW)</b>	257.4	220.7	183.9	
<b>Bore and Stroke (mm)</b>	60.4 × 57	60.4 × 57		51 × 51	60.4 × 48	48 × 38	<b>Bore and Stroke (mm)</b>	98 × 97	98 × 89		
<b>Operation Range (rpm)</b>	DF20A: 5,300-6,300 DF15A: 5,000-6,000 DF9.9B: 4,700-5,700	DF20A: 5,300-6,300 DF15A: 5,000-6,000 DF9.9B: 4,700-5,700		DF9.9A: 5,200-6,200	DF6A: 4,750-5,750 DF5A: 4,500-5,500 DF4A: 4,000-5,000	5,250-5,750	<b>Operation Range (rpm)</b>	5,700-6,300	5,700-6,300		
<b>Fuel Delivery System</b>	Battery-less Electronic Fuel Injection	Battery-less Electronic Fuel Injection		Carburetor	Carburetor	Carburetor	<b>Fuel Delivery System</b>	Electronic Fuel Injection	Electronic Fuel Injection		
<b>Oil Pan Capacity (L)</b>	1.0	1.0		0.8	0.7	0.38	<b>Oil Pan Capacity (L)</b>	8.0	8.0		
<b>Alternator</b>	12V 12A	12V 12A	12V 6A	12V 6A	12V 5A (op.)	-	<b>Alternator</b>	12V 54A	12V 54A		
<b>Trim Type</b>	Power Tilt	Manual Trim and Tilt/Power Tilt		Manual Trim and Tilt	Manual Trim and Tilt	Manual Trim and Tilt	<b>Trim Type</b>	Power Trim and Tilt	Power Trim and Tilt		
<b>Gear Ratio</b>	2.08:1	2.08:1		2.08:1	1.92:1	2.15:1	<b>Gear Ratio</b>	2.29:1	2.08:1		
<b>Control System</b>	Mechanical	Mechanical		Mechanical	Mechanical	Mechanical	<b>Control System</b>	Drive By Wire	Drive By Wire		
<b>Recommended Fuel**2</b>	RON91/AKI87	RON91/AKI87		RON91/AKI87	RON91/AKI87	RON91/AKI87	<b>Recommended Fuel**2</b>	RON94/AKI89	RON91/AKI87		
<b>Propeller Selection (pitch)</b>	7"-12"	7"-12"		7"-11"	6"-7"	5.3/8"	<b>Propeller Selection (pitch)</b>	12"-31.5"	15"-27.5"(R/R) 17"-26"(C/R)**4		

All propellers are the 3-blade type. please inquire at your local dealer for details of the propeller.

\*1: Dry Weight: Including battery cable, not including propeller and engine oil. \*2: RON: Research method (minimum octane rating) AKI: (R+M)/2 method(minimum pump octane rating), (Only North America)

\*3: DF20AT/DF9.9BT only. \*4: DF300AP only.

## FEATURES

●=Standard Equip. ○=Optional Equip.

	20AT/ 15AT/9.9BT	20AR/ 15AR/9.9BR	20A/15A/ 9.9B	9.9A	6A/5A/4A	2.5		350AMD (STEALTH LINE)	300AP (STEALTH LINE)	250AUN (STEALTH LINE)
<b>INTEGRATED STEERING</b>							<b>INTEGRATED STEERING</b>	●		
<b>SUZUKI DUAL LOUVER SYSTEM</b>							<b>SUZUKI DUAL LOUVER SYSTEM</b>	●		
<b>SELF-ADJUSTING TIMING CHAIN</b>							<b>SELF-ADJUSTING TIMING CHAIN</b>	●		
<b>SUZUKI ANTI-CORROSION SYSTEM</b>	●	●	●	●	●	●	<b>SUZUKI ANTI-CORROSION SYSTEM</b>	●	●	●
<b>OVER-REV. LIMITER</b>	●	●	●	●	●	●	<b>OVER-REV. LIMITER</b>	●	●	●
<b>TILT LIMIT SYSTEM</b>							<b>TILT LIMIT SYSTEM</b>	●	●	●
<b>WATER DETECTING SYSTEM</b>							<b>WATER DETECTING SYSTEM</b>	●	●	●
<b>FRESH WATER FLUSHING SYSTEM</b>	●	●	●	●	●		<b>FRESH WATER FLUSHING SYSTEM</b>	●	●	●
<b>DUAL WATER INLET</b>							<b>DUAL WATER INLET</b>	●	●	●
<b>SUB WATER INLET</b>							<b>SUB WATER INLET</b>		●	●
<b>KEYLESS START SYSTEM</b>							<b>KEYLESS START SYSTEM</b>	○		
<b>SDSM**1</b>	○	○	○				<b>SDSM**1</b>	○	○	○
<b>OFFSET DRIVESHAFT</b>							<b>OFFSET DRIVESHAFT</b>	●	○	○
<b>2-STAGE GEAR REDUCTION</b>							<b>2-STAGE GEAR REDUCTION</b>	●	●	●
<b>HIGH ENERGY ROTATION</b>							<b>HIGH ENERGY ROTATION</b>		●	●
<b>SUZUKI DUAL PROP SYSTEM</b>							<b>SUZUKI DUAL PROP SYSTEM</b>	●		
<b>VARIABLE VALVE TIMING</b>							<b>VARIABLE VALVE TIMING</b>	●		
<b>MULTI-STAGE INDUCTION</b>							<b>MULTI-STAGE INDUCTION</b>		●	●
<b>SUZUKI SELECTIVE ROTATION</b>							<b>SUZUKI SELECTIVE ROTATION</b>			
<b>SUZUKI PRECISION CONTROL</b>							<b>SUZUKI PRECISION CONTROL</b>	●	●	
<b>NOISE REDUCTION</b>							<b>NOISE REDUCTION</b>	●	●	●
<b>OVERHEAD TANK</b>					●		<b>OVERHEAD TANK</b>			
<b>AUTOMATIC TRIM**3</b>							<b>AUTOMATIC TRIM**3</b>	○		
<b>GAS ASSIST SYSTEM</b>							<b>GAS ASSIST SYSTEM</b>		○	○
<b>THREE-WAY STORAGE</b>					●		<b>THREE-WAY STORAGE</b>			
<b>SUZUKI TROLL MODE SYSTEM**2</b>							<b>SUZUKI TROLL MODE SYSTEM**2</b>	○		
<b>SUZUKI EASY START SYSTEM</b>							<b>SUZUKI EASY START SYSTEM</b>	●	○	○
<b>LEAN BURN CONTROL SYSTEM</b>	●	●	●				<b>LEAN BURN CONTROL SYSTEM</b>	●	●	●
<b>DUAL INJECTOR</b>							<b>DUAL INJECTOR</b>	●	●	●
<b>O<sub>2</sub> SENSOR FEEDBACK CONTROL SYSTEM</b>							<b>O<sub>2</sub> SENSOR FEEDBACK CONTROL SYSTEM</b>			
<b>SHALLOW WATER DRIVE</b>		●	●	●	●		<b>SHALLOW WATER DRIVE</b>		●	●

\*1: available by using with SMG4 \*2: available by using with SMG4/Troll Mode Switch Panel

Please read your Owner's Manual carefully. Never operate the boat while under the influence of alcohol or other drugs. Always wear a personal flotation device when boating. Please operate your outboard safely and responsibly.

Suzuki encourages you to operate your boat safely and with respect for the marine environment.

Specifications, appearances, equipment, colours, materials and other items of "SUZUKI" products shown in this catalogue are subject to change by manufacturers at any time without notice and they may vary depending on local conditions or requirements. Some models are not available in some territories. Each model might be discontinued without notice. Please enquire at your local dealer for details of any such changes. Actual body colours might differ from the colours in this brochure.

Correct at time of print: January 2026



Suzuki GB PLC, Steinbeck Crescent,  
Snelshall West, Milton Keynes, Bucks MK4 4AE  
Find us at: [marine.suzuki.co.uk](https://marine.suzuki.co.uk)

